

ITEM NO.	PART NO.	DESCRIPTION	QTY.	MSRP
1	H135	Cuff-Lynx, 2" m cuff x 2" mpt	1	\$3.99 ea
2	P561	cap, 6", threaded, w/ 2" npt	1	\$23.99 ea
3	G031	gasket, 3.25" i.d. x 5.88" o.d.	1	\$6.99 ea
4	H359	basket, strainer, 4.5 DIA x 12.5	1	\$36.99 ea
5	G084	gasket, 4.55" x 5.5"	1	\$4.99 ea
6	H231	screw, 10-32 x 1" phil pan head, s/s	4	\$0.99 ea
7	H081	lower bracket, tm booster	2	\$1.99 ea
8	P563A	body, lint hog, new style	1	\$34.99 ea
9	G004-A	gasket, vacuum motor	3	\$6.99 ea
10	P567	adapter, pvc, 2" fslip x 2" mpt	1	\$4.99 ea
11	A926	elbow, inlet assembly 2"	1	\$15.99 ea
12	H230	screw, 10-32 x 1/2" phil pan head, s/s	13	\$0.99 ea
13	H082	upper bracket, tm booster	1	\$2.99 ea
14	E373	level switch, vacuum shut-off, rear threads	1	\$13.99 ea
15	B103	elbow, brass, 90 deg, 1/4"mpt x 1/4" fpt	1	\$4.49 ea
16	B105	bushing, brass, 3/8"mpt x 1/4"	1	\$3.19 ea
17	B210	bushing, brass, 1/2"mpt x 3/8" fpt, hex	4	\$2.49 ea
18	P680	elbow, pvc 1/2" fmt x 1/2" fms	1	\$2.00 ea
19	P677-5	pipe, pvc, 1/2" x 20'	1	\$1.99 ft
20	P679	adapter, pvc, 1/2" fpt x s	1	\$3.99 ea
21	H299	washer, 11/16" id x 1-1/2" od x .075, s/s	5	\$0.99 ea
22	B216	nipple, brass, 3/8" x close	2	\$1.99 ea
23	H210	washer, 1/4" flat, s/s	18	\$0.99 ea
24	H213	washer, 1/4" lock, s/s	2	\$0.99 ea
25	H201	bolt, 1/4-20 x 1/2", hex head, zinc	2	\$0.99 ea
26	H216	nut, lock, 1/4-20, nylon insert, s/s	14	\$0.99 ea
27	H333	mesh filter, auto dump, 1/2" npt	1	\$12.99 ea
28	B236	elbow, brass, 90 deg, 1/2" barb x 3/8" fpt	1	\$14.49 ea
29	P684	adaptor, pvc 2, fmsl x fmt	1	\$6.99 ea
30	P682-9	pipe, pvc, 2"	1	\$7.99/ft
31	P683	elbow, 45 deg, 2" pvc	1	\$8.99 ea
32	G021	screen, mesh filter, 2-3/8" dia	1	\$4.99 ea
33	G022	filter, foam, 2-3/8" x 1"	1	\$2.99 ea
34	H316	bolt, 1/4x1-1/2", hex head zinc	2	\$0.99 ea
35	H379	bracket, front, small	1	\$3.99 ea
36	P537	tank, truckmount booster	1	\$215.00
37	H124	Cuff-Lynx, 2" mpt x 2" female cuff	3	\$3.99 ea
38	H121	cuff-lynx, 2" plug	2	\$3.99 ea
39	H768	bolt, 1/4-20 x 3/4" serrated hex flange, zinc	14	\$0.99 ea
40	H211	washer, 1/4" id x 1" od, flat, s/s	4	\$0.99 ea
41	G052	washer, buna 1-1/8" od x 3/16" id	4	\$1.99 ea
42	H485	handle, breeze and dx	2	\$6.99 ea
43	G091	gasket, 7", vac lid	1	\$11.99 ea
44	G090	lid, vac tank, clear, 7"	1	\$36.99 ea
45	H304	screw, #8 x 5/8 phil oval, s/s	6	\$0.99 ea
46	PH615-25	sol hose, 1/2", 3045psi, black	1	\$8.99 ft
47	C381	pump out, 115v	1	\$187.49 ea
48	H273	nut, kep, #10-32 zinc	14	\$0.99 ea
49	H185	screw, 10-32 x 1-1/4", phil flat full thread, black oxide	4	\$0.99 ea
50	PH615-8	sol hose, 1/2", 3045psi, black	1	\$8.99 ft
51	B173	ferrule, 1/2", brass	4	\$0.99 ea
52	B132	adapter, brass, 1/2" barb x 1/2" mpt	1	\$9.49 ea

ITEM NO.	PART NO.	DESCRIPTION	QTY.	MSRP
53	B270	coupling, 3/4" fpt x 1/2" fpt	1	\$14.99 ea
54	B271	bushing, hex, 3/8" mpt x 1/2" fpt	1	\$6.99 ea
55	B205B	QD, 1/2" npt x 3/4" mgh, pump-out	1	\$3.99 ea
56	B204	qd, 3/4" female x female garden hose	1	\$9.99 ea
57	B221	plug, brass, 3/4", garden hose	1	13.99 ea
58	H194	coupler, 2" dia x 2.5" length, s/s	1	\$10.00 ea
59	H020	nut, lock, 2", steel	1	\$4.99 ea
60	H486	latch, front	1	\$13.99 ea
61	E512B	light, indicator, 125v (amber)	1	\$9.99 ea
62	E550	power cord, pigtail, 30", 12/3, black	1	\$11.49 ea
63	H220	fitting, strain relief, cord	1	\$3.19 ea
64	H221	nut, lock, 1/2" steel	1	\$1.99 ea
65	G068	bumper, 7/8" x 1/4" head	1	\$1.99 ea
66	P571	base, tm booster	1	\$164.99 ea
67	E564	controller, circuit light	1	\$62.99 ea
68	H186	screw, 10-32 x 3/4, phil flat full thread	4	\$0.99 ea
69	H636	plate, switch, ml/trkr, 3 hole	1	\$6.99 ea
70	H389	screw, 10-32 x 1/2" SHCS, alloy	1	\$0.99 ea
71	E515	switch, rocker, 2 position	3	\$13.99 ea
72	E370	controller, water level, dual pump or vac	1	\$94.99 ea
73	C317	fan, cooling, 115V	1	\$21.49 ea
74	H343	screw, 10 x 5/8" hex head, zinc	12	\$0.99 ea
75	H296	guard, cooling fan, wire	3	\$2.99 ea
76	H342	bolt, 1/4-20 x 1" hex head, s/s	8	\$0.99 ea
77	H667	caster, 3", Black Hub, Gray Tread	2	\$14.99 ea
78	H227	axle, 15.60" x .50" dia	1	\$9.99 ea
79	H239	wheel, 8"	2	\$28.99 ea
80	H042	c-clip, 12mm, external	2	\$0.99 ea
81	H253	plate, dual manifold, 9" x 13"	1	\$14.99 ea
82	PH628-11	vac hose, 2", black, wire reinforced	3	\$8.99 ft
83	H501	vac support, 3 stage, 4-1/16"	6	\$4.99 ea
84	C302LA	vac motor, 3 stage, low amp	2	\$139.99 ea
85	P685	inlet, 2"	1	\$10.99 ea
86	H217	clamp, hose, 2-1/4 dia	5	\$1.49 ea
87	H544	cuff hose, 2 X 2, wire reinforced	1	\$12.49 ea
88	H202	bolt, 1/4x20x3/4" hex head	6	\$0.99 ea
89	P735	manifold, single vac, no gasket	2	\$14.99 ea

**ITEMS NOT SHOWN**

PART NO.	DESCRIPTION	QTY.	MSRP
H141	Cuff-Lynx, 2" to 1.5" reducer	1	\$3.99 ea
G008	piglet filter	1	\$6.29 pak
G076	filter bag, 3.5" metal O-ring, mesh bag	1	\$4.99 ea
H110	Cuff-Lynx, 2" hose x 2" fem swivel Cuff-Lynx	1	\$3.99 ea
H136	Cuff-Lynx, 2" hose x 2" male swivel Cuff-Lynx	1	\$3.99 ea
E530	power cord, ext, 50', 12/3 black	1	\$74.99 ea
AD127	stop sign, register your product	1	n/a
ADM-7300	manual, tm vacuum booster	1	n/a

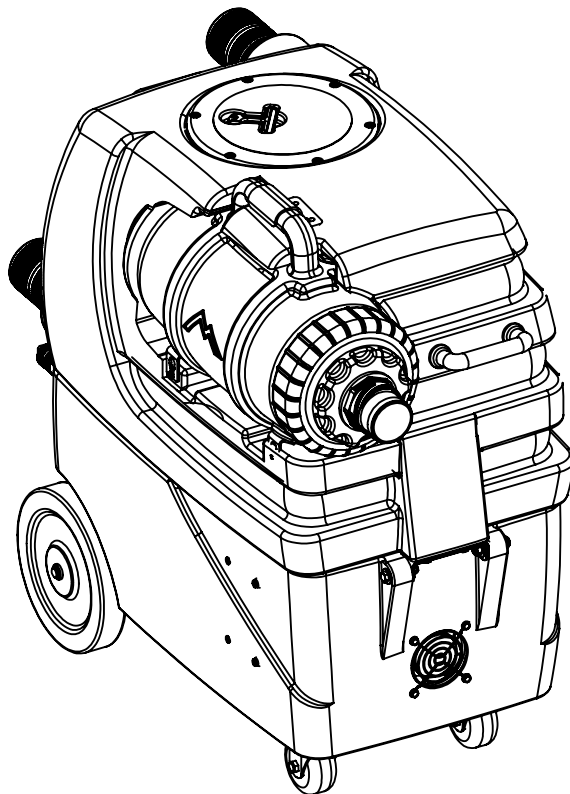

	NAME	DATE	MYTEE PRODUCTS, INC.		
DRAWN	M.LoBarbera	2/2014	858-679-1191		
CHECKED			TITLE:		
COMMENTS:			Booster, TM		
PROPRIETARY AND CONFIDENTIAL					
THE INFORMATION CONTAINED IN THIS DRAWING IS THE SOLE PROPERTY OF MYTEE PRODUCTS, INC. ANY REPRODUCTION IN PART OR AS A WHOLE WITHOUT THE WRITTEN PERMISSION OF MYTEE PRODUCTS, INC. IS PROHIBITED.			SIZE	DWG. NO.	REV
			C	7300-SLA	B
			SCALE: 1:32	DO NOT SCALE DRAWING	SHEET 1 OF 3

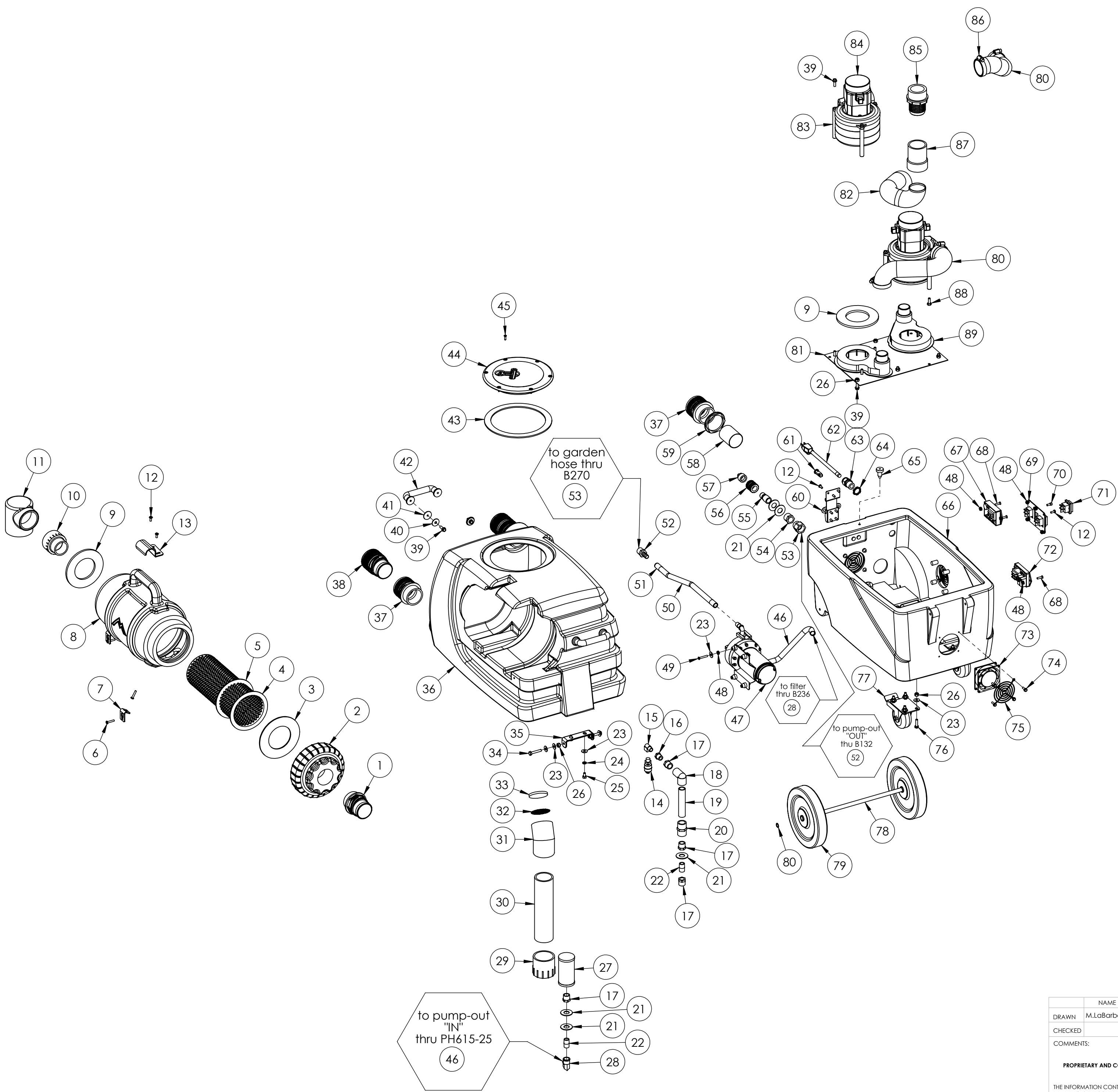

NAME		DATE	MYTEE PRODUCTS, INC.	
DRAWN	M.LaBarbera	2/2014	858-679-1191	
CHECKED			TITLE:	
COMMENTS:			Booster, TM	
PROPRIETARY AND CONFIDENTIAL			SIZE DWG. NO. REV	
THE INFORMATION CONTAINED IN THIS DRAWING IS THE SOLE PROPERTY OF MYTEE PRODUCTS, INC. ANY REPRODUCTION IN PART OR AS A WHOLE WITHOUT THE WRITTEN PERMISSION OF MYTEE PRODUCTS, INC. IS PROHIBITED.			C 7300-SLA B	
SCALE: 1:32		DO NOT SCALE DRAWING	SHEET 2 OF 3	

REVISIONS

REV.	DESCRIPTION	DATE	APPROVED
OD	ORIGINAL DRAFT	2/2014	JFL
A	ADDED G084	3/11/2014	ML
B	UPDATED FLOAT ASSEMBLY	11/7/2014	ML

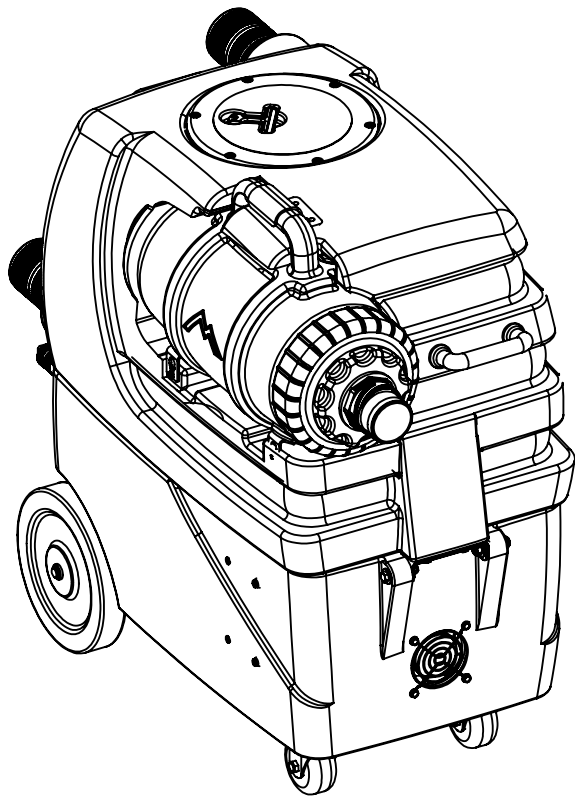

	NAME	DATE	MYTEE PRODUCTS, INC. 858-679-1191	
DRAWN	M.LaBarbera	2/2014	TITLE:	
CHECKED			Booster, TM	
COMMENTS:				
PROPRIETARY AND CONFIDENTIAL				
THE INFORMATION CONTAINED IN THIS DRAWING IS THE SOLE PROPERTY OF MYTEE PRODUCTS, INC. ANY REPRODUCTION IN PART OR AS A WHOLE WITHOUT THE WRITTEN PERMISSION OF MYTEE PRODUCTS, INC. IS PROHIBITED.			SIZE C	DWG. NO. 7300-SLA
			SCALE: 1:32	REV B
			DO NOT SCALE DRAWING	SHEET 3 OF 3